

NUMBER	REVISION	DATE

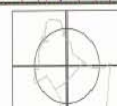

**MECKLENBURG-UNION**  
**METROPOLITAN PLANNING ORGANIZATION**  
 600 East Fourth Street  
 Charlotte, North Carolina 28202-2853

UNION COUNTY  
 NORTH CAROLINA

PROJECT: CHESTNUT LANE	
DRAWN BY: THOROUGHFARE RELOCATION	
PLAN VIEW	
SCALE: 1" = 400'	DRAWN BY: S. BASRAM
DATE: 4/5/2005	SHEET NO: 1 OF 1

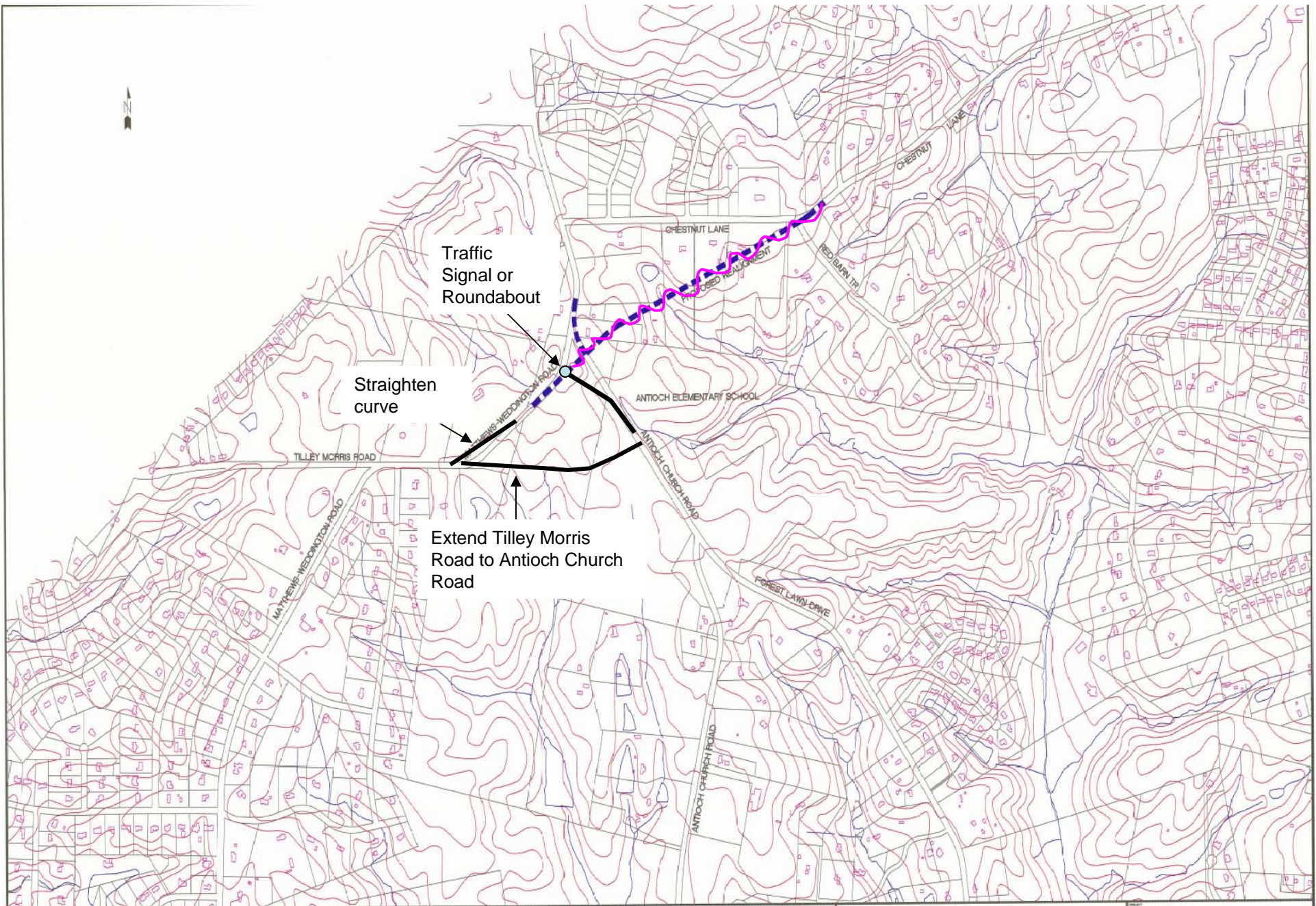

NUMBER	REVISION	DATE

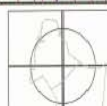

**MECKLENBURG-UNION**  
**METROPOLITAN PLANNING ORGANIZATION**  
 600 East Fourth Street  
 Charlotte, North Carolina 28202-2853

UNION COUNTY  
 NORTH CAROLINA

PROJECT: CHESTNUT LANE	
DRAWING TITLE: THOROUGHFARE RELOCATION	
PLAN VIEW	
SCALE: 1" = 400'	DRAWN BY: S. BASKAM
DATE: 4/5/2005	SHEET NO: 1 OF 1

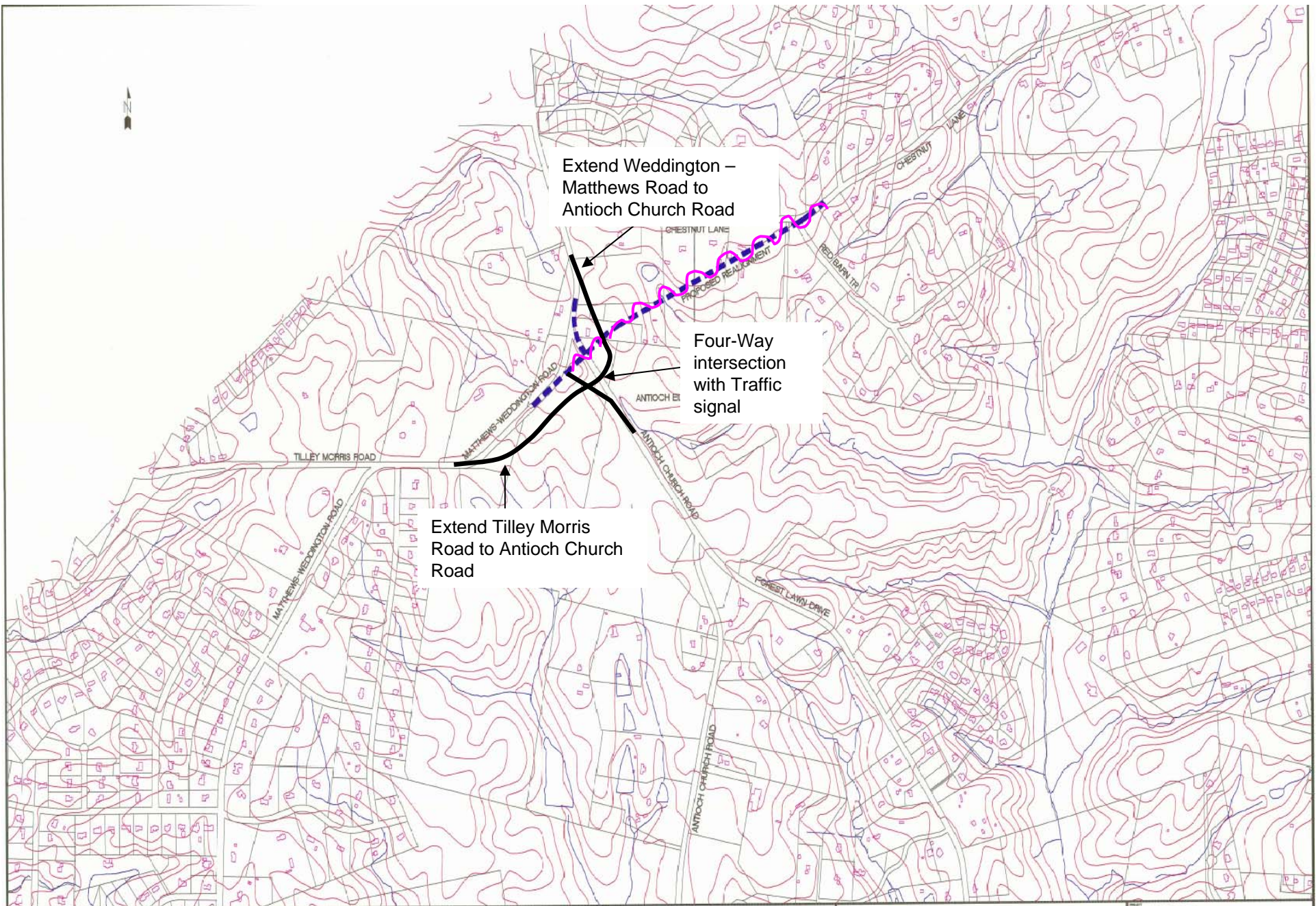

Extend Weddington –  
Matthews Road to  
Antioch Church Road

Four-Way  
intersection  
with Traffic  
signal

Extend Tilley Morris  
Road to Antioch Church  
Road

NUMBER	REVISION	DATE

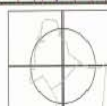

**MECKLENBURG-UNION**  
**METROPOLITAN PLANNING ORGANIZATION**  
 600 East Fourth Street  
 Charlotte, North Carolina 28202-2853

UNION COUNTY  
 NORTH CAROLINA

PROJECT: CHESTNUT LANE	
DRAWING TITLE: THOROUGHFARE RELOCATION	
PLAN VIEW	
SCALE: 1" = 400'	DRAWN BY: S. BASKAM
DATE: 4/5/2005	SHEET NO: 1 OF 1



Short-Term ——— (orange line)  
 Long-Term ——— (green line)



Maybe

One person in favor of keeping proposed alignment

Improve Curve

Relocate intersection to the high point; add turn lanes; signal if warranted

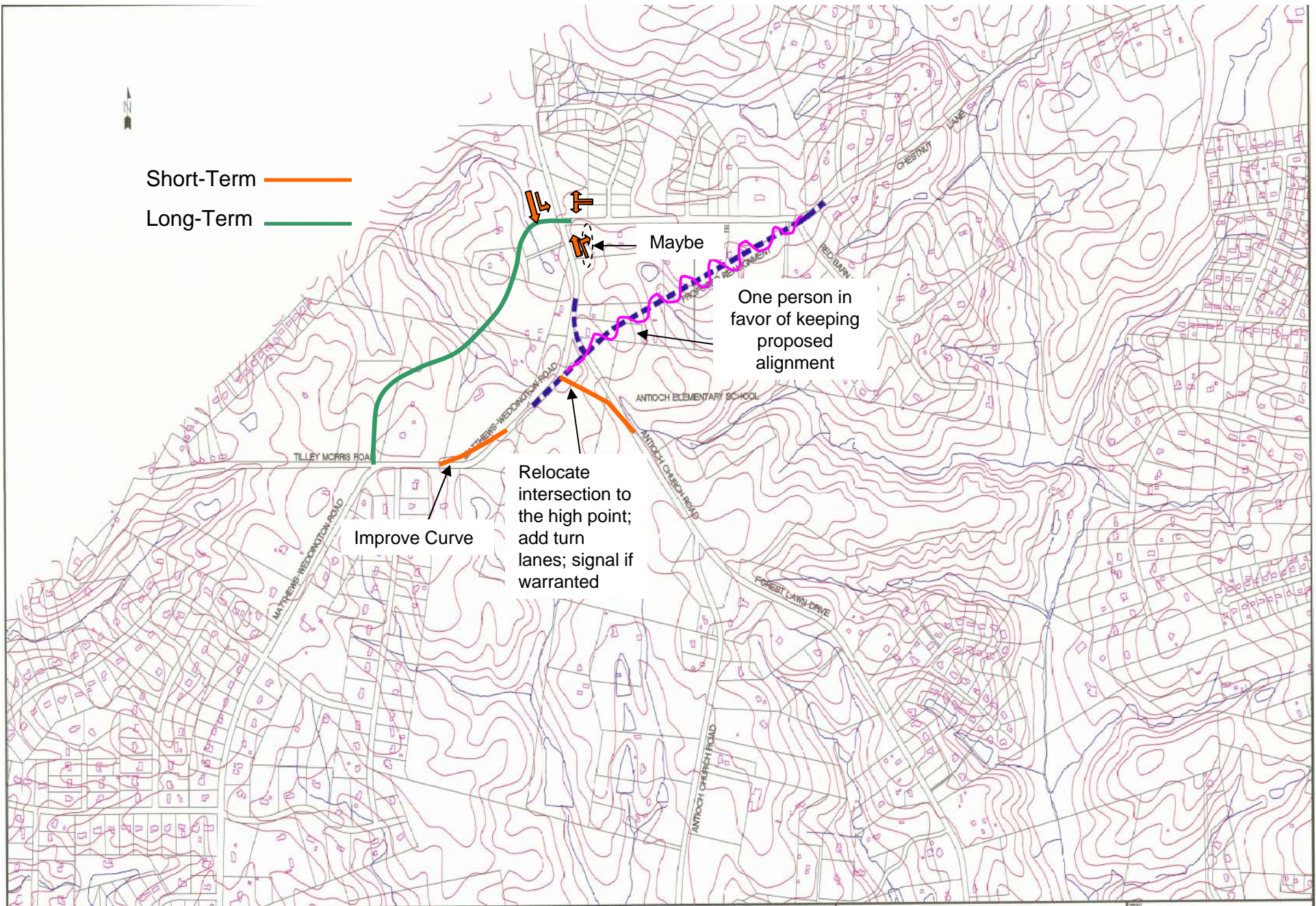

NUMBER	REVISION	DATE

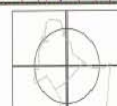

**MECKLENBURG-UNION**  
**METROPOLITAN PLANNING ORGANIZATION**  
 600 East Fourth Street  
 Charlotte, North Carolina 28202-2853

UNION COUNTY  
 NORTH CAROLINA

PROJECT: CHESTNUT LANE	
DRAWN BY: THOROUGHFARE RELOCATION	
PLAN VIEW	
SCALE: 1" = 400'	DRAWN BY: S. BASKAM
DATE: 4/5/2005	SHEET NO: 1 OF 1

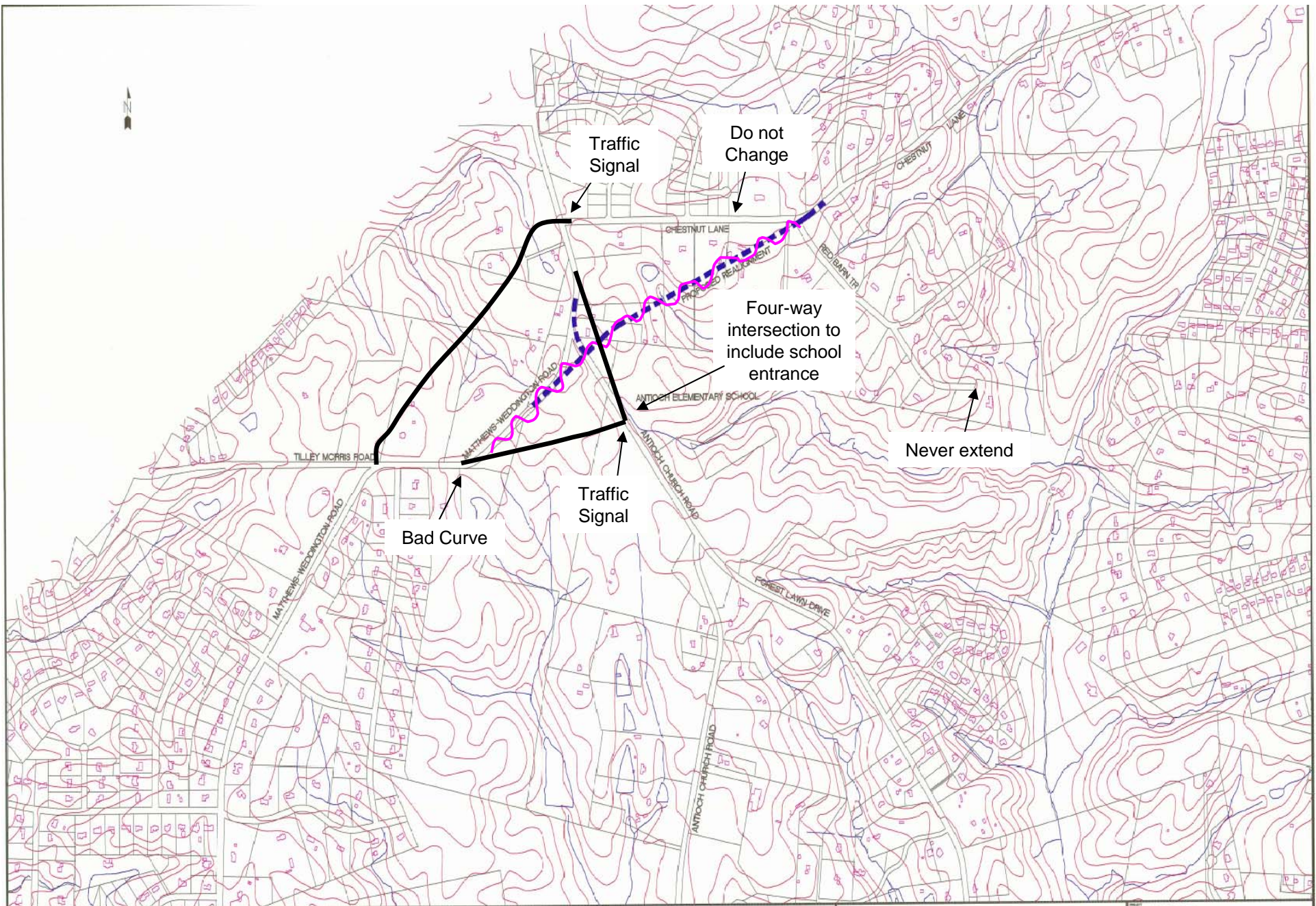

NUMBER	REVISION	DATE

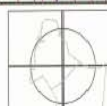

**MECKLENBURG-UNION**  
**METROPOLITAN PLANNING ORGANIZATION**  
 600 East Fourth Street  
 Charlotte, North Carolina 28202-2853

UNION COUNTY  
 NORTH CAROLINA

PROJECT: CHESTNUT LANE	
DRAWING TITLE: THOROUGHFARE RELOCATION	
PLAN VIEW	
SCALE: 1" = 400'	DRAWN BY: S. BASKAM
DATE: 4/5/2005	SHEET NO: 1 OF 1

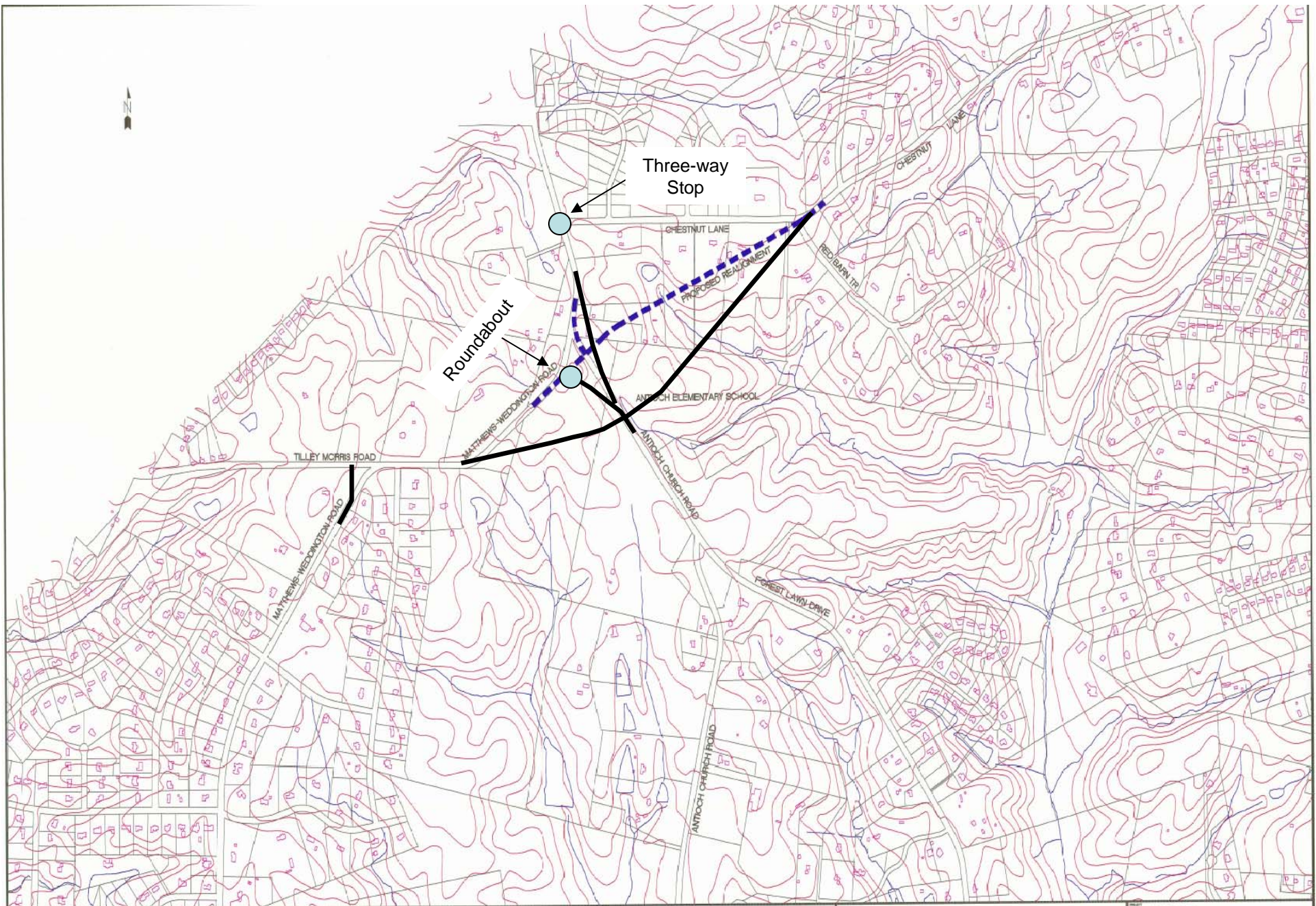

NUMBER	REVISION	DATE

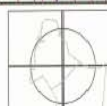

**MECKLENBURG-UNION**  
**METROPOLITAN PLANNING ORGANIZATION**  
 600 East Fourth Street  
 Charlotte, North Carolina 28202-2853

UNION COUNTY  
 NORTH CAROLINA

PROJECT: CHESTNUT LANE	
DRAWING TITLE: THOROUGHFARE RELOCATION	
PLAN VIEW	
SCALE: 1" = 400'	DRAWN BY: S. BASKAM
DATE: 4/5/2005	SHEET NO: 1 OF 1

Short-Term: Signal at Chestnut Lane and Weddington-Matthews Road; Weddington-Matthews Road and Antioch Church Road

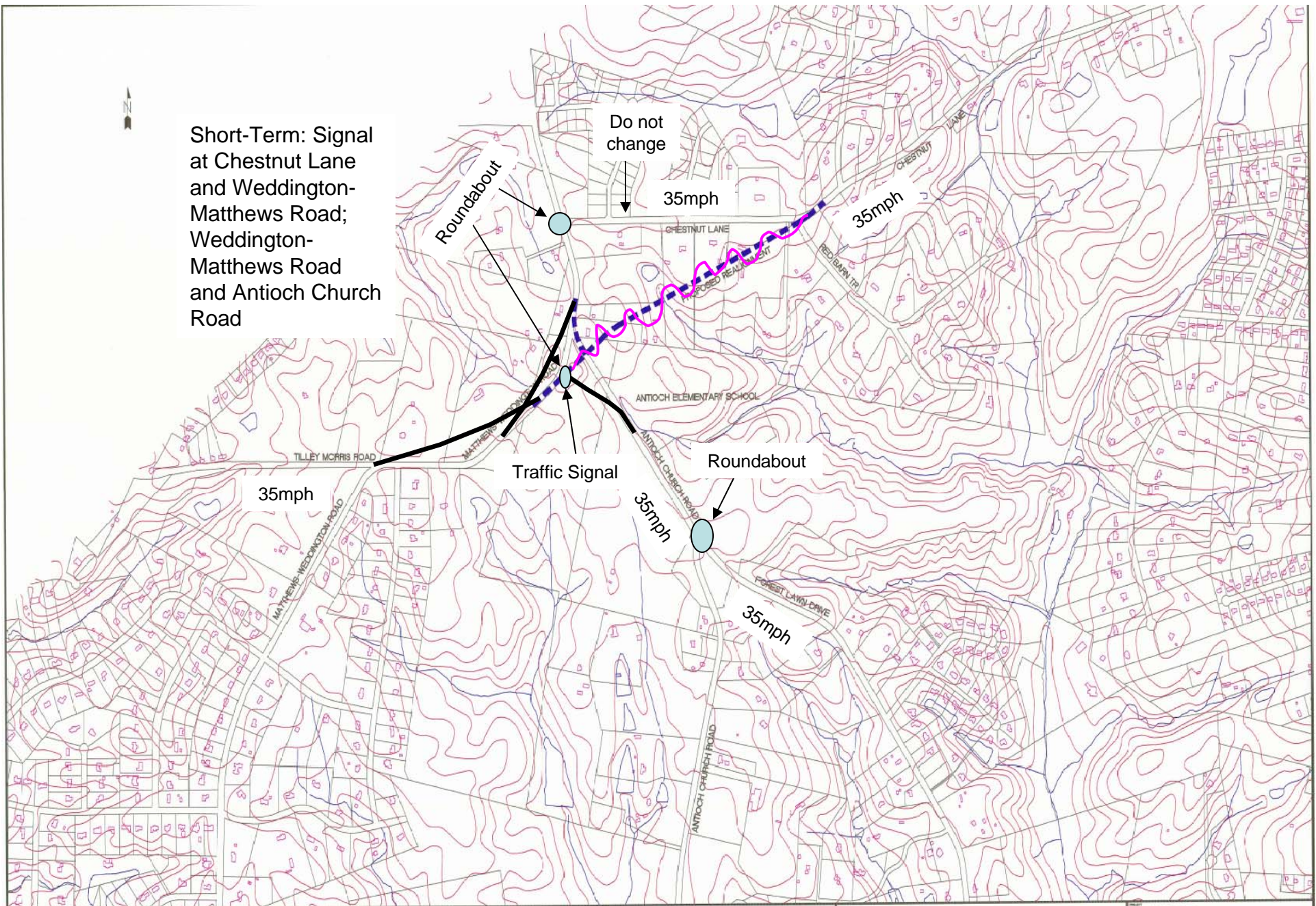

NUMBER	REVISION	DATE

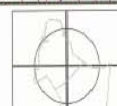

**MECKLENBURG-UNION**  
**METROPOLITAN PLANNING ORGANIZATION**  
 600 East Fourth Street  
 Charlotte, North Carolina 28202-2853

UNION COUNTY  
 NORTH CAROLINA

CHESTNUT LANE	
THOROUGHFARE RELOCATION	
PLAN VIEW	
SCALE: 1" = 400'	DRAWN BY: S. BASKAM
DATE: 4/5/2005	SHEET NO: 1 OF 1

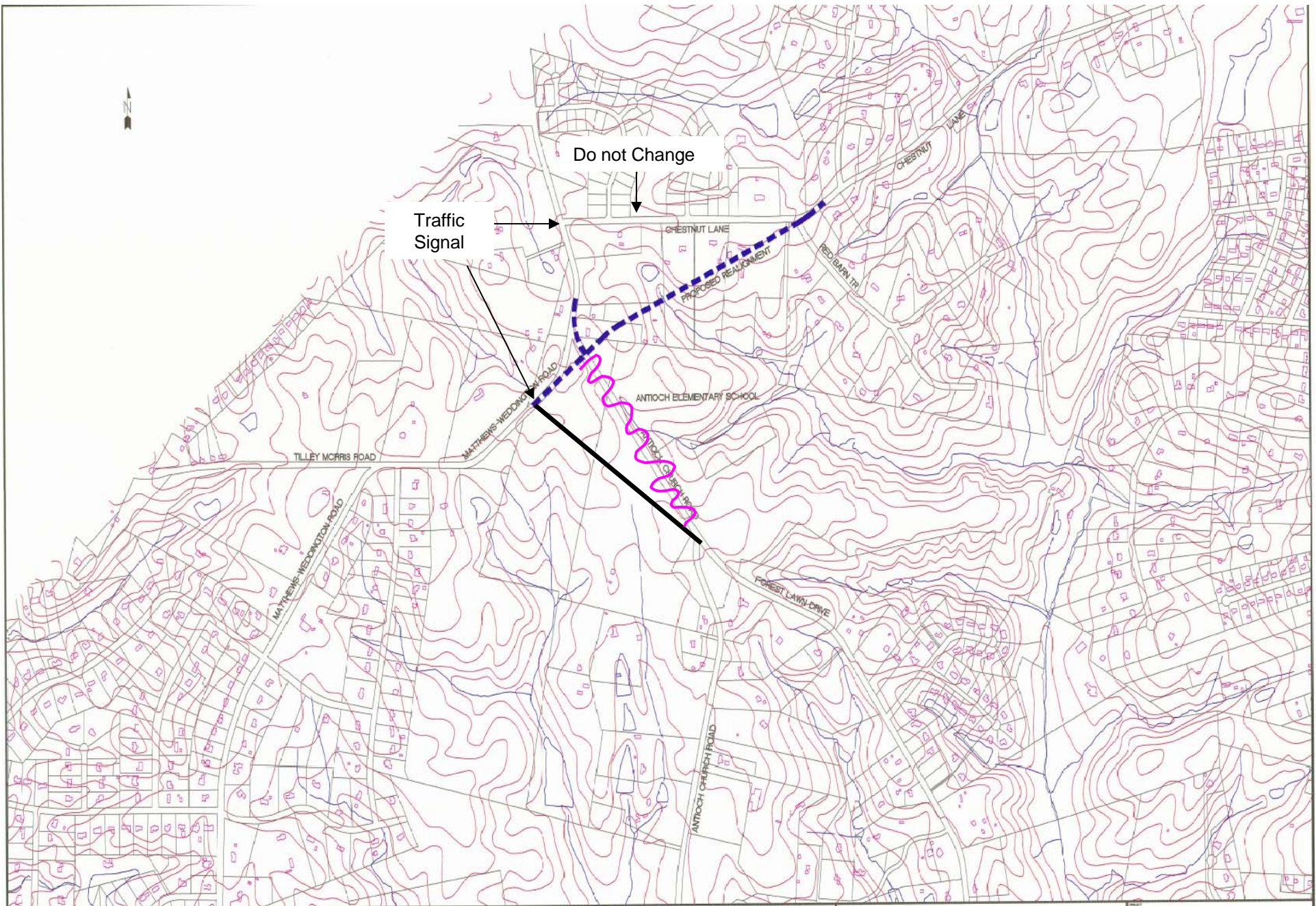

NUMBER	REVISION	DATE

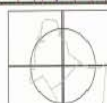

**MECKLENBURG-UNION**  
**METROPOLITAN PLANNING ORGANIZATION**  
 600 East Fourth Street  
 Charlotte, North Carolina 28202-2853

UNION COUNTY  
 NORTH CAROLINA

PROJECT: CHESTNUT LANE	
DRAWN BY: THOROUGHFARE RELOCATION	
PLAN VIEW	
SCALE: 1" = 400'	DRAWN BY: S. BASKAM
DATE: 4/5/2005	SHEET NO: 1 OF 1

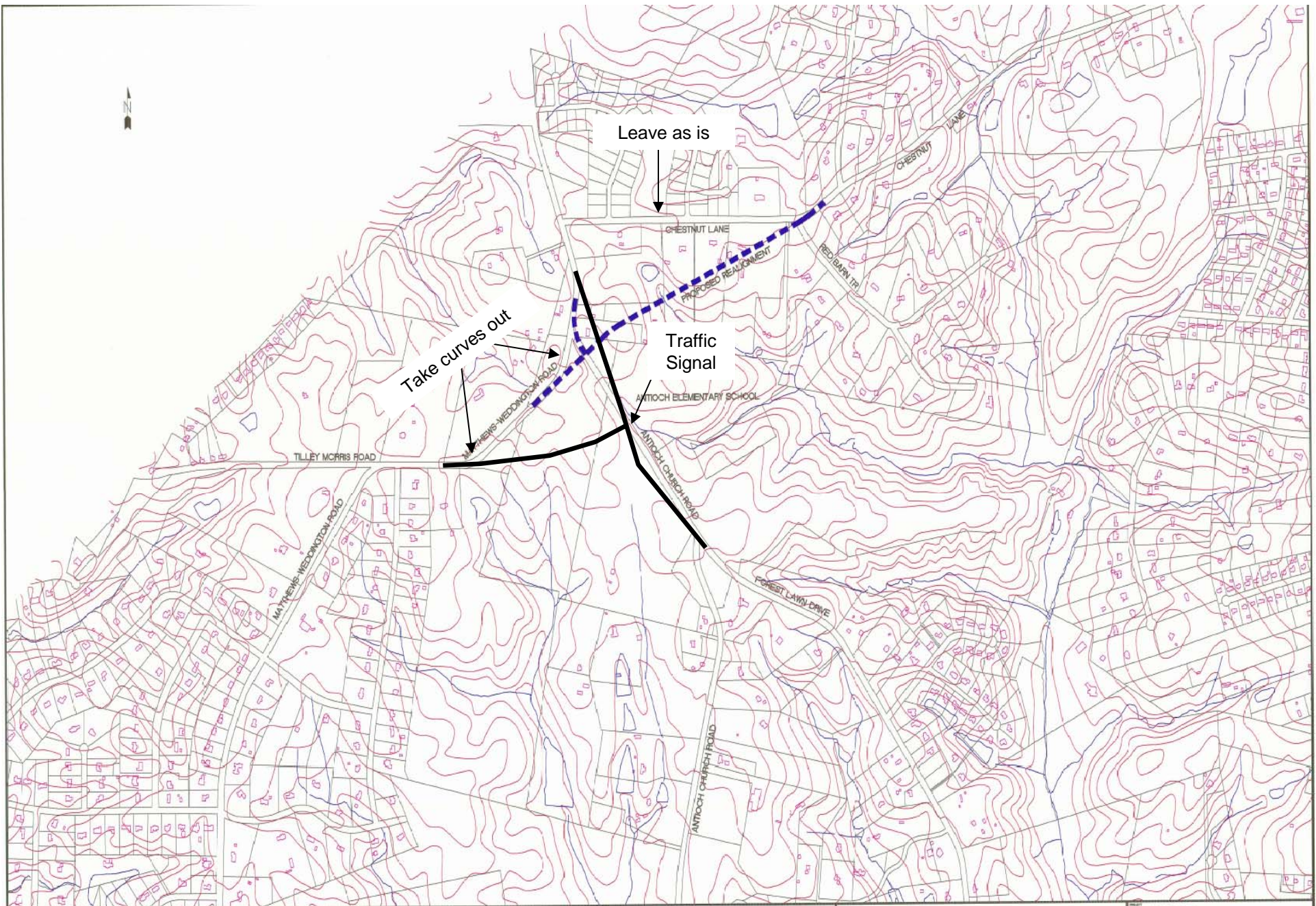

NUMBER	REVISION	DATE

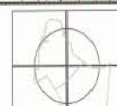

**MECKLENBURG-UNION**  
**METROPOLITAN PLANNING ORGANIZATION**  
 600 East Fourth Street  
 Charlotte, North Carolina 28202-2853

UNION COUNTY  
 NORTH CAROLINA

PROJECT: CHESTNUT LANE	
DRAWN BY: THOROUGHFARE RELOCATION	
PLAN VIEW	
SCALE: 1" = 400'	DRAWN BY: S. BASKAM
DATE: 4/5/2005	SHEET NO: 1 OF 1